

SERVICE SHEET

Corner Oil Stove Pot Removal 06-05-15

FIG 1
REAR VIEW

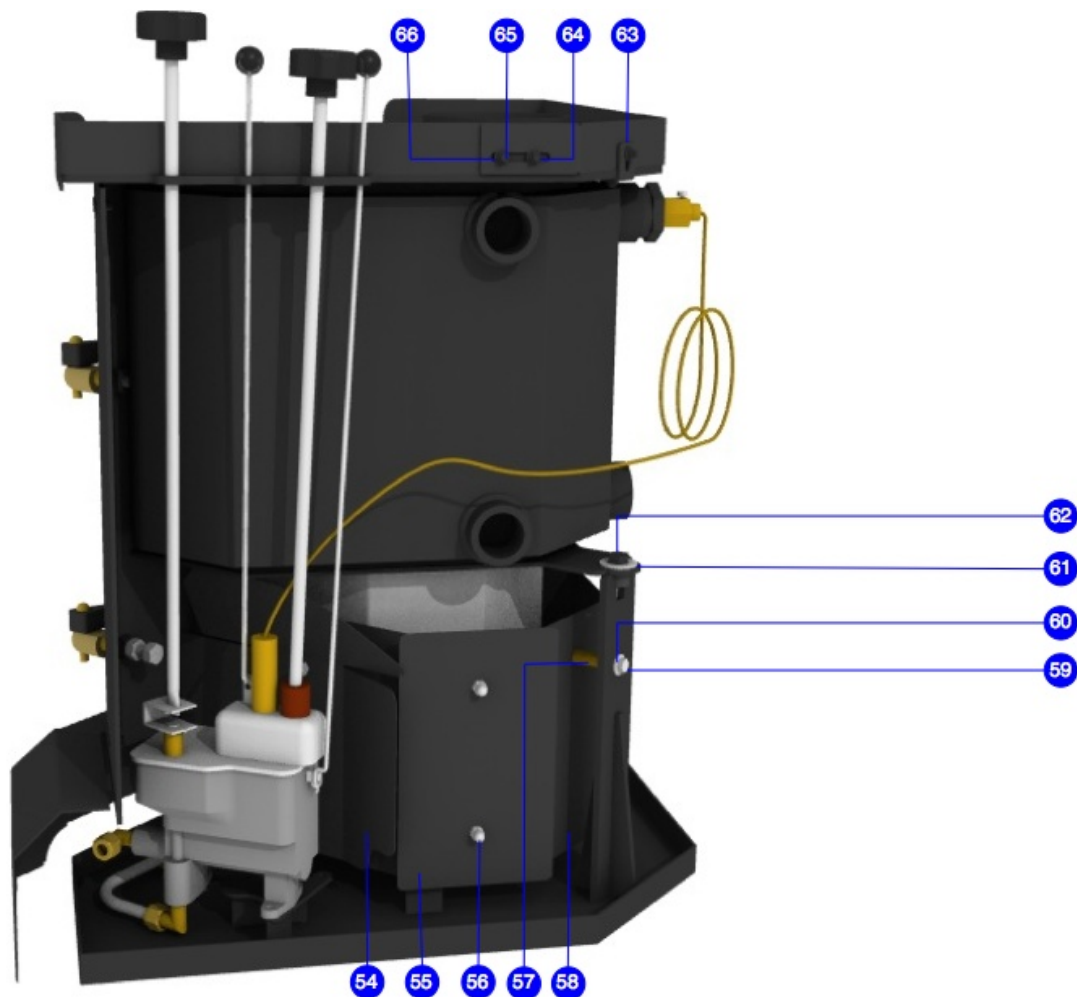

Note

Stoves without boilers do not have the thermostat arrangement fitted to the oil control valve top plate. See 17 fig 3 and only have one oil flow control rod and one oil trip lever rod.

FIG 2
FRONT VIEW

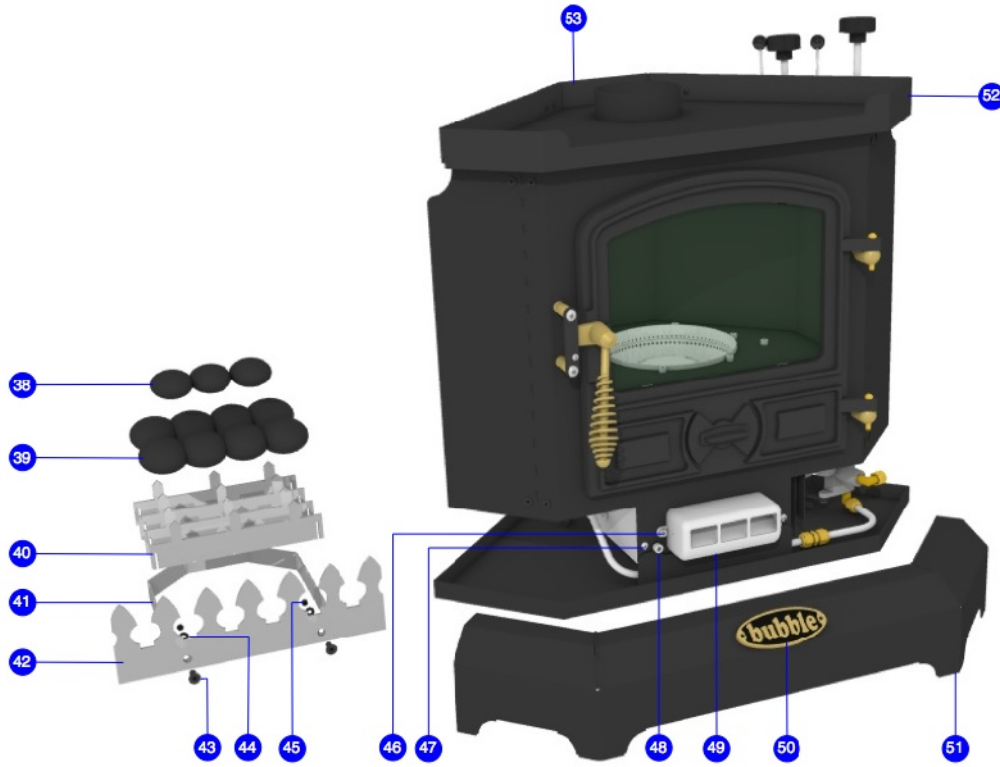
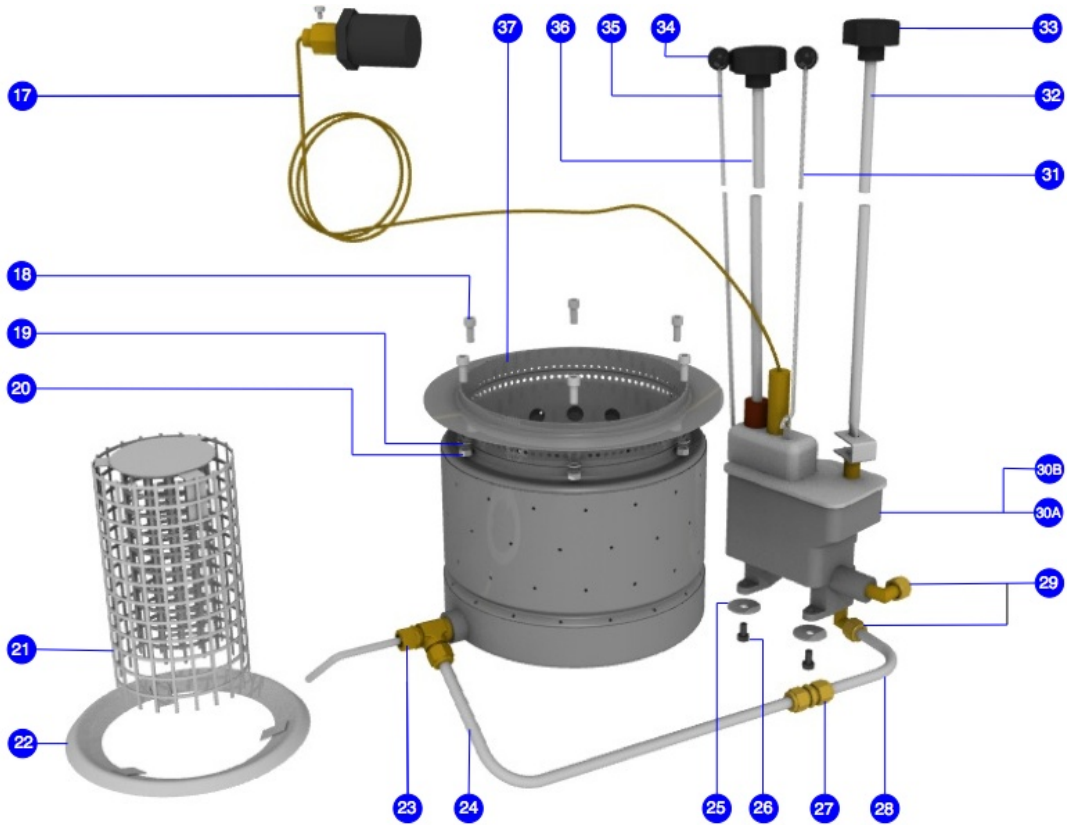

FIG 3
POT & OIL CONTROL VALVE ARRANGEMENT



Introduction

The corner stove is constructed in two major components namely the upper body section and the lower support and integral drip tray section.

It is necessary to follow the step by step procedure detailed below but in essence the upper part of the appliance is only secured to the lower section by three fasteners, setscrew 62 in fig 1 and the two small setscrews 48 in fig 2.

Remove the door by simply lifting it up off its hinges.

Remove the Flue Pipe.

Remove the Front fender

Remove the left and right hand side panels which are secured by two m6 countersunk setscrews at the top of each panel.

Split the oil supply tube at 27 on fig 3 and remove the downstream section at the descaler 23 fig 3

If the appliance is a boiler stove it will be necessary to drain the system, disconnect the boiler connections and remove from the boiler the phial sensing device 17 fig 3

Remove each of the control rods and note that the oil flow rod is held in place by a split pin, the oil trip rod has to be bent and deformed to remove it and straightened after replacement.

Remove the oil feed pipe 24 in fig 3

Remove the setscrew 62 in fig 1 and the two small setscrews 48 in fig 2.

To avoid damage, remove the combustion air restrictor 49 fig 2

At this stage the upper body should lift up and free of the bottom section.

The pot is housed within a stainless outer box which is fastened to the front face and pot closure plate via a series of self tapping screws. 47 fig 3

Remove the descaling device by unscrewing it anticlockwise, use a threadlock sealant when replacing.

Remove the self tapping screws holding the stainless box to the front plate and closure plate.

Using a sharp knife separate the box from its mating surfaces which are the front plate and the closure plate.

When the box is removed undo the fasteners (18 fig 3) securing the pot to the closure plate and then remove the pot.

On older model stoves the mating joints on the stainless box were sealed with a type of fire cement which has now been superseded with black high temperature silicone rubber sealant and so it is necessary, before rebuilding, to reseal the joints to make sure that the box is airtight and the only air getting in to it comes through the combustion air restrictor which has been previously removed.

REBUILD

Do a dummy run to check that the new pot fits correctly; this means that when the new pot is fitted and the stainless box is fitted back on to the stove body, the descaler can be fitted back in through the side of the stainless box. If it does not then it may be necessary to open up the fastener holes slightly and rotate the pot to the correct alignment position.

The reason for this is that the pot manufacturer does not always solder the descaling device nipple into the pots with consistent accuracy.

After the pot and descaler alignment have been checked, rebuild in reverse order using the black high temperature silicone sealant to form new seals between the stainless box and the stove body.

When replacing the aluminium control rods gently straighten them back into position.

© HARWORTH HEATING LTD and BUBBLE PRODUCTS 06-05-15

This publication may not be copied by any means, without written permission from the authors.

Products made by Bubble Products, are subject to continuous development and improvement and it is consequently acknowledged that due to this process there may be some omissions and errors.

This publication is intended only to assist the reader in the maintenance of this product and therefore Bubble Products shall not be liable for any loss or damage whatsoever arising from the use of any information, error or omission found in this publication.

Only suitably qualified persons are allowed to carry out maintenance on this product.